

“ ”1

“... ”

[ . . . 772, . 40 . ;  
 . : , 1996, . 98, . 4].

, , 1272 .

V ” , ( ,

), ,

( . ?), -

1272 , - “ ”2

(Regno de Leon) “... 5 . ”

“... ,

1 “ ” [ . . : , 2010, . 180].

2 “ ” ( ) (www.wikipedia.org). 1952 . ( V . ,

” [ , 2003, 129, . 10; , 2008, (1339)

. 20]<sup>3</sup>.  
[ V , 1963, . 375; , 2010, . 17;  
.: , 2008, . 133–136].<sup>4</sup>

(1562–1618), 20  
“... – –  
[Biblioteka..., Rpk L.P.1300, s. 1349–1352; Walczak, 1960, t. V, s. 57–77; , 1996, . 31;  
, 2008, . 73; 1994, . 227, 282–288]<sup>5</sup>.

1519–1762  
 (“Loko S. Basilii Monachorum...”) [Swietochowski, 1969, t. XI, s. 90, n. 29].  
“ – ” (“Ordo S. Basilii”)  
, 2009, . 644]\*. [ , 1997, . 78–124;

res sacra –  
“

---

<sup>3</sup> , “ ...” – 1290 .  
V .  
“ ” – “ ”,  
<sup>4</sup> , ( )  
1241 . “ ”  
<sup>5</sup> “ ” : , ”.

( ),  
a [Zyła, 1923, s. 1].

[ , 2008, . 73; 1994, . 227, 282–288].

\*

...” [ ,2010, .180].

( “ ”)

“ ” ( ).

( , ). , ,

’ V .,

’ ,

’ 6,

’ - “... “ ” -

’ “... ”

’ “ ”

’ - “ ” -

’ [ , 2010, .180].

’ 20- V .

’ : “... ” [ ,2001, .772, .40 .: .: ,1996, .98, . 4- ,2001, 9-10, .21].

’ : 1 -

1671 .( - ) 2 - 20-

V . ( - ),

’ ( ),

---

6

’

’ “... ( - . . ) ;

’ [ , 1886, .6].

/

’ 22 1591 .

[ , 2011, .78, 177-178].

’ 1340 . [ , 1886, .3, 8],

’ V .



( : , ( ) ). (Plateae Ruthenicae )

), , ( . . . : .

“... ”), 8 . : 1 - ,

( 2 - , 1272 , - ); ( ) , “ ”

), ( : , - ( ) , ( - - ) .

“ ” , ( )<sup>9</sup> ,

( ) [ , 2009, .644].

[Swietochowski, 1969, t. XI, s. 90, n. 29]. [ , 2008, .95].

)

( „ ” „ ”).

8

( - , , , , , ) „ ( ) „ ( ) , , „ ”

10 - 50 30

( „ ” )

“ ” “ ”

(

“... ”<sup>11</sup>

“ ”

( “ ”

)

V - V<sup>12</sup>

( “ ”

“ ” [Swietochowski, 1969, s. 93, ryc. 2],

---

<sup>10</sup> “... ( - . . )

... [Markowski, 1969, s. 76].

( ) “ ” , 30-

<sup>11</sup> “ ( ) ...

[ , 2008, . 73].

<sup>12</sup> , 1/3

1406 . [Swietochowski, 1969, s. 103].

“...  
 2012  
 ” [www.uk/wikipedia.org].<sup>13</sup>  
<sup>14</sup>  
<sup>15</sup>  
 ( ... ).  
 ;  
<sup>15</sup>  
 ( ... )  
 1234, 1250, 1270  
 [Widman, 1928, s. 9–13; ..., 1994, .75],  
 1360 . [ ..., 2001, V . ( ... : 1371 . [ ..., 1979, .8]; ... :  
 9–10, .6], ... 1199–1205 . [ ..., 2001,  
 ( ... ), ... ( ... )].  
 1371 . [ ..., 1972, .30; ..., 1994, .75].

---

<sup>13</sup> ( ... ).  
<sup>14</sup> : “...  
 ( ... )” [Markowski, 1969, s. 74].  
 [Markowski, 1969, s. 83, 36  
 (“ ... ”), ... ( ... )].  
 8  
 36  
 (!) – 24 [Swietochowski, 1969, s. 91],  
<sup>15</sup> [Swietochowski, 1969, s. 93, ryc. 2],  
 (“ ... ”).  
 “ ... ”

( V ),

( - - ) 1371 ?

1375

( ?), ( ?) 17.

18.

( - )

(1363 .) 19.

V .

( . . . “ ” ),

res sacra

---

<sup>16</sup> “...*Monasterium fundatum ante annum Domini 1297*” “...*Loko S.Basilii Monachorum...*”  
 [Swietochowski, 1969, s. 90, n. 29, , 2009, . 641].

<sup>17</sup>

<sup>18</sup> 1519 1762 [ ..., . 301, . 614; , 1994, . 76].<sup>18</sup>

<sup>19</sup> V . “Leopolis Triplex” (“ 1363 ..”)  
 - 1437 . [ , 2008, . 13].



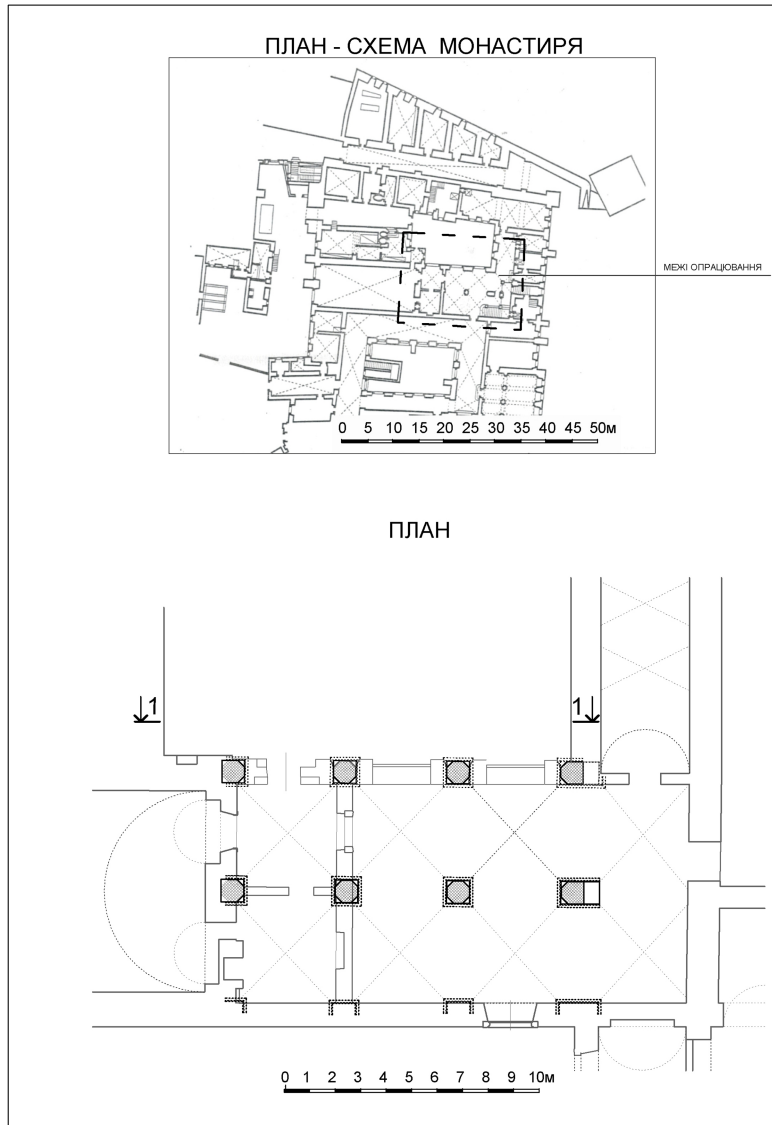

Fig. 1. Above: schematic plan of former Dominican cloister with market subject of research; below: plan of “central-symmetry atrium” (by Y. Lukomskyi and V. Bevz) or, according to the author, part of columns of Early Medieval chapel at St. John the Baptist Cathedral church (by the author).

<b>1270</b>		: “visitavit dominus et erexit, anno 1270” [ . . : - V . : 1234, 1250 ( ), 1340 . [Widman, 1869, s. 32–48; Janusz, 1928, s. 9–13; , 1994, . 76].
<b>1297</b>	-	“...monasterium fundatum ante annum Domini 1297”, “...loko S.Basilii Monachorum...” [Swietochowski, 1969, s. 90, 29; 2009, s. 641]. “ ”, [Baracz, 1861, s. 443].
<b>1371</b>		[ ..., 1972, . 30; , 1994, . 75]
<b>1375</b>	( , , ?), ( )	[ , 1970, . 106–108; . . 9; , 1994, . 76].
<b>1391</b>	- - Praedicatorum), (Ordo fratrum V .	[Acta grodzkie i ziemskie. – Lwow, 1870. – T. II. – S. 34].

1391 .

( V . )

---

( )  
s. 9–13; ( ), 1994, . 75], : 1234, 1250, 1270 . [Widman, 1869, s. 32–48; Janusz, 1928,

( )– V . 1270 . ( V .,  
)

1861, s. 443]. [ , 1996, . 31<sup>20</sup>; Baracz, 1519–1762 .  
s. 90, n. 29; , 2009, . 644]. [Swietochowski, 1969, t. XI,

: – “ ” ?  
( “ ”  
( 1988  
“ ” 9  
“ ”  
( ),  
( ), ( ),  
“ ”  
( )

---

20  
[Zyla, 1923, s. 1].

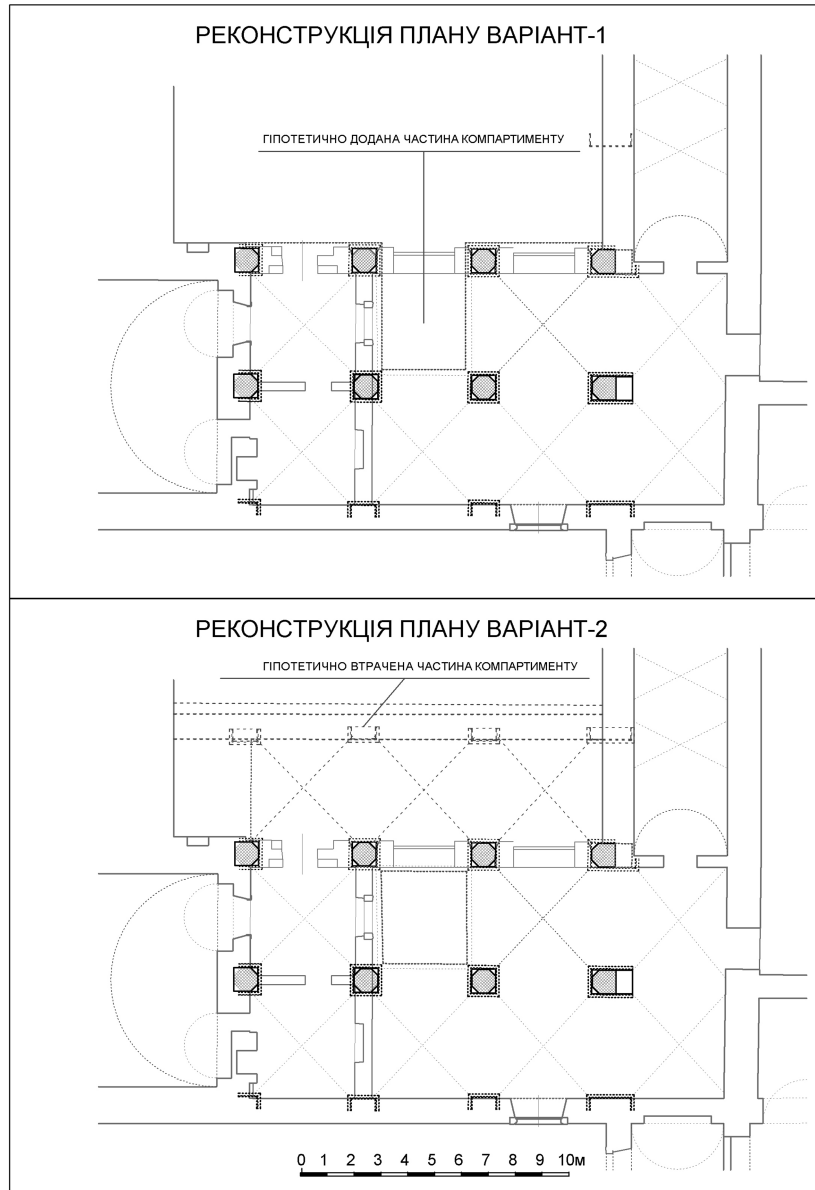

. 2. ( 2 – ).  
Fig. 2. Two variants of graphic reconstruction of researched object (variant 2 – with reconstruction of lost part of kompartment).

( ) , , , , 23 - 4  
( ) , , ( ) , , )  
17,5 (18) 4 . ( ?), -  
( ?).

(opus mixtum)

1. ( )  
“ ”  
23 1,  
1955–1956 3 , [ , 1961, . 123]<sup>21</sup>.  
21 20  
( )  
, 24–26 , 9,0–9,5 , 12–13 ( - ) .  
- 16 23 : -  
, 28 , 13 9 17,5–18,0 ; :  
28 , 23 9 . 20,  
22 .  
1992 ( . , 103) “ ” . . . .<sup>23</sup>,  
“... 8 , - V .” [ , 1992, . 92–93; 1997, . 6, . 117–118].  
- 1997  
11. , - 2,86 .  
, (26,5–28×12–13×9 ) . : 1 –  
; 2 – ( 2 ); 3 – ( ) ; 4 –

---

<sup>21</sup> ( ) .  
[ , 1961, . 123–124].  
<sup>22</sup> . . . .  
<sup>23</sup> “ ” “ ”



...  
 ( .4).  
 ( )  
 /  
 ( .4).  
 ( .4).  
 ( .1)  
 "...  
 " .  
 ( 2).  
 (20 ).  
 ( ) [Nickel, 1971, br. 61–63]<sup>25</sup>.  
 " ...<sup>26</sup>  
 : ( )  
 ? -  
 " V- V .  
 ( )

---

<sup>25</sup>  
<sup>26</sup> :  
 ( )





... , ...

... ( ) ,

1272 ,

( ?)

( ?),

( .4),

(

1282

( ?)

**1** :

(

( ?),

[ , 2012, .35].

1246 1247





— ; — , — , —  
 ( .1: ).  
 (0,33 )  
 ( — /)

( .1: ).  
 — — — — —  
 / , / — /  
 , , / , — ,  
 : ( .3).

( ) ( .1: ).  
 / /

( .1: ).  
 “ ”  
 / , —  
 / ( .2).

( .1: ).

1. ;
2. ;

3. ' , (
  4. ' -2); , (
  5. -1); ;
  6. ' - ;
  7. ' , -
- 05.11.2012 .
- “ ”
- 2008 ” .- .- 229 .
- 1992 ( - ) .- .- 102 .
- 1997 //
- .- .6.- .114-118.
- 1997 ( , 11).- .- 35 .
- 2005 ' //
- .- .- .15.- .22-37.
- 1979 - .- .- 55 c.
- 2010 .- .- 388 c.
- 2008 // : .- .-
- .3-29.
- 1972 .- .- 30 .
- 2003 // .- .- 129.- .10.
- 2008 6749 (1241) // : -
- .- .- .2.- .133-136.
- 2008 // - .- .- .80-105.
- 1994 // , .- .-
- .75-78.

2004 . – 1282 . V . –  
. – . . . 772. – . 40.

2010 ...// . – . – 388 .

2002 ( 1992–2000 )//  
. – . – . 244. – . 578–607.

2001 ( )// . – . –  
9–10. – . 18–23.

2001 ( )// . – . – 9–  
10. – . 6–8.

2008 ( – V )//  
: . – . – . 42–75.

1963 . – . – . 15. – . 375.

2010 . – . – 35 .

1853 //  
. – . – . 1. – . 1. – . 3–4.

1997 //  
V “ ”. – – – ,  
2–6 1995 . – . – . 78–124.

1961 1955–1956 . // . –  
. – . 118–126.

1970 IV . //  
. – . – . 106–108.

2009 -  
// . – . – . 636–645.  
, . 1 31. . – . 9

1886 //  
, 300- . – . 1. –  
. – . – . 1–12.

*Acta...*

1870 Acta grodzkie i ziemskie. – Lwów. – T. II. – S. 34.

*Bar cz S.*

1861 Rys dziejów zakonu kaznodziejskiego w Polsce. – Lwów. – 443 s.

*Biblioteka...*

Biblioteka Polskiej Akademii Nauk. – Gdańsk. – Rpk L.P.1300. – S. 1349–1352.

---

*Nickel H.*

1971 Osteuropäische Baukunst des Mittelalters. – Leipzig. – Obr. 61–63.

*Swietochowski R.*

1969 Na marginesie artykułu F. Markowskiego “Gotycki klasztor dominikanów we Lwowie w świetle r kopisu z XVI wieku // Kwartalnik Architektury i Urbanistyki. – T. XIV. – N. 29.– S. 89–103.

*Janusz B.*

1928 Zabytki monumentalnej architektury Lwowa. – Lwów. – S. 9–13.

*Walczak R.*

1960 Pami tniki Marcina Grunewega // Studia ródloznawcze. – Warszawa-Pozna . – T. V. – S. 57–77.

*Widman K.*

1869 Ko cioł pod wezwaniem w. Jana Chrzciciela we Lwowie. – Lwów. – S. 32–48.

*Zyła W.*

1923 Ko cioł i klasztor Dominikanów we Lwowie. – Lwów. – 98 s.

***Mykola BANDRIVS'KYI***

#### ISSUE OF LOCALIZATION OF "MEGALE EKKLYEZIYA" OF RUS' PRINCES IN L'VIV

An attempt to localize "MEGALE EKKLYEZIYA" – cathedral church of Russian princes on the modern map of L'viv is made at this article. It definitely must to exist in the city, which from 1272 became the capital of Principality of Galicia-Volhynia and which included such large and significant cities as Kyiv, Volodymyr, Siver and others. On the base of analysis of the available written sources the author confirms the previously suggested possibility of the existence of church of St. John the Baptist on the place of coming Dominican monastery. The modern church of St. John the Baptist on Staryi Rynok appeared not earlier than XIV century, but it, as the author argues, was the heir of St. John's dedication and traditions of its predecessor (the early medieval cathedral church located at the beginning of the Virmenska street), which, at that time, already was strongly altered by Dominican builders. First attempt to determine the time and cause of the creation of large three-sections hall with white-stone columns, which today contains exposition of L'viv Museum of the History of Religion. Based on architectural measurements, historical and archaeological research the author concludes that it was a chapel-tomb (of St. Luke the Evangelist?), which was built simultaneously with a chapel of St. Peter and Paul Apostles at Old Rus' Cathedral of St. John the Baptist. The latter, according to an analysis of the presently known written sources and literature was actually situated, as suggested by the author on the place of later Dominican monastery.